

advanced FLOW engineering

Instruction Manual P/N: 46-70240 / 46-70242

Make: **GM** Model: **Trucks** Year: **1999-2016** Engine: **V6-4.3L & V8-4.8L/5.3L**
Transmissions: **4L60-E / 4L60E / 4L65E / 4L70E / 4L75E**



- Please read the entire instruction manual before proceeding.
- Ensure all components listed are present.
- If you are missing any of the components, call customer support at 951-493-7100.
- Ensure you have all necessary tools before proceeding.
- Do not attempt to work on your vehicle when the engine is hot.



Retain factory parts for future use.

Label	Qty.	Description	Part Number
A	1	Transmission Pan - Machined Fins	05-60372
B	16	M8 x 1.25 x 25mm bolts	03-50231
C	16	M8 Washers	03-50228
D	1	3/4" NPT Plug	03-50222
E	1	1/8" NPT Plug	03-50029
F	1	Gasket	05-60461

Installation will require the following tools:

13mm socket, 15mm socket, socket driver (ratchet), 1/2" extension, 1/2" ratchet, 3/16" allen wrench, 6mm allen wrench, 4mm allen wrench, T40 torx wrench, thread locker, teflon tape, lint-free rag.

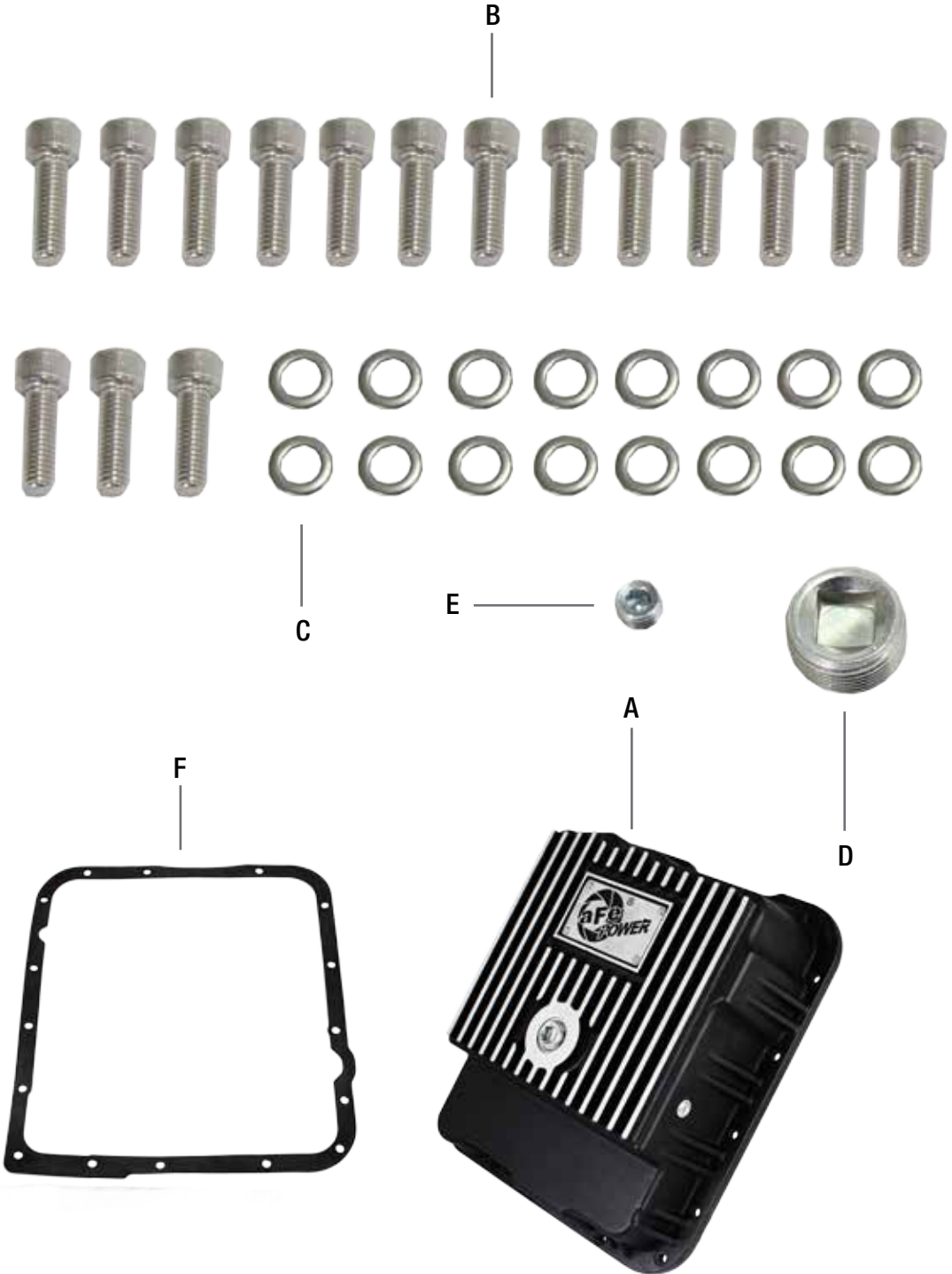

**Figure A****Refer to Figure A for steps 1-3**

- 1: Park vehicle on flat, dry surface and engage the parking brake.
- 2: Using a T40 torx driver remove the shifter linkage bracket.
- 3: Remove the shifter cable from the shift lever on the transmission by prying the shifter cable. it will pop off the shift lever.

**Figure B****Refer to Figure B for steps 4-6**

4. Remove the transmission mount nut from the transmission crossmember and using a hydraulic jack, lift the rear of the transmission an inch. This will allow for extra room needed to install the aFe transmission pan
5. Using a 13mm socket, remove the 16 bolts holding the transmission pan. As you remove the transmission pan bolts, the fluid will start to drain.
6. Remove the transmission pan and drain the fluid completely.



Figure C

Refer to Figure C for step 7-9

***aFe recommends replacing filter at this time.**

7. Remove the stock filter from the transmission.
8. Wipe any residual transmission fluid from the transmission with a lint free rag.
9. Install the transmission filter into the transmission.

INSTALL



Figure D

Refer to Figure D for step 10-12

10. Install teflon tape on the 3/4" NPT plug, and on the 1/8" NPT plug.
11. Use a 3/16" allen wrench, install the 1/8" NPT plug into the transmission pan.
12. Using a 1/2" extension and a 1/2" ratchet , install the 3/4" NPT plug into the transmission pan.

**Figure E****Refer to Figure E for step 13-14**

13. Using the supplied gasket, install the aFe transmission pan using a 6mm allen wrench and 16 – M8 x 1.25 x 25mm bolts and 16 – M8 washers.
14. Tighten the bolts in a crisscross pattern to 12-14 lb-ft.

INSTALL



Figure F

Refer to Figure F for steps 15-16

15. Reinstall the transmission shift linkage by pushing firmly on the shifter cable. It will snap back on.
16. Then install the factory torx screws into the shifter cable linkage bracket and tighten.



Figure G

Refer to Figure G for step 17-18

17. The transmission dipstick is located in the engine compartment. Fill the transmission to the factory specifications using the recommended oil. Reinstall dipstick.

***Note: The aFe pan holds approximately 6 quarts of transmission fluid. This is 2 more than the stock pan.**

18. Your installation is now complete.

***Transmission fluid expands. Always check oil level per factory recommendations when the truck is hot.**

*** Caution*: A running truck will be hot. Take every precaution necessary to prevent being burned.**

Page left blank intentionally



Page left blank intentionally

Page left blank intentionally



Direct Fit Air Filter



P/N: 10-20013

Air Intake



P/N: 54-10872

Throttle Body Spacer



P/N: 46-34004

Twisted Steel Header



P/N: 54-74102

Exhaust System



P/N: 49-44009

Cat-Back Exhaust



P/N: 54-10091

aFe Power Hat



P/N: 40-10083

aFe Diesel Tee



P/N: 40-30221 (M)

P/N: 40-30222 (L)

P/N: 40-30223 (XL)

P/N: 40-30224 (2XL)

P/N: 40-30225 (3XL)

Watch G-Shock



P/N: 40-10125

aFe Power Backpack



P/N: 40-33203

To purchase any of the items above, view airflow charts, dyno graphs, photos, and video; please go to aFepower.com.

Warranty

General Terms:

- aFe warrants their products to be free from manufacturer's defects due to workmanship and material.
- This warranty applies only to the original purchaser of the product and is non-transferrable.
- Proof of purchase of the aFe product is required for all warranty claims.
- Warranty is valid provided aFe instructions for installation and/or cleaning were properly followed.
- Proper maintenance with regular inspections of product is required to insure warranty coverage.
- Damage due to improper installation, abuse, unauthorized repair or alteration is not warranted.
- Incidental or consequential damages or cost, including installation and removal of part, incurred due to failure of aFe product is not covered under this warranty.
- All warranty is limited to the repair and/or replacement of the aFe part. To request Return Goods Authorization ("RGA"), email RGA@afepower.com or call (951)493-7100. Upon receipt of the RGA, you must return the product to the address provided in the RGA, freight prepaid and accompanied with a dated proof of purchase and the RGA. Upon receipt of the defective product and upon verification of proof of purchase, aFe will either repair or replace the defective product within a reasonable time, not to exceed thirty days.

Product Category	P/N Prefix	Warranty duration
Direct OE Replacement Filters	10, 11, 30, 31, 71, 73	Life of the vehicle
Racing Filters	18	1 year
Universal	21, 24, 72, TF	2 years
Air Intake Systems	50, 51, 54, 55, 75, TR, TA, TL	2 years
Exhaust Systems	49	2 years
Intercoolers & Intercooler Tubes	46-2	2 years
Intake Manifolds	46-1	2 years
Differential Cover	46-7	Life of the vehicle
Exhaust Manifolds	46	2 years
Throttle Body Spacers	46-3	2 years
Turbochargers	46-6	2 years*
Fluid Filters	44	90 days
Pre-Filters	28	2 years
Heavy Duty OE Replacement	70	2 years
PowerSports OE Replacement	81, 87	2 years
PowerSports Intake Systems	85	2 years

No other warranty expressed or implied applies nor is any person or advanced FLOW engineering authorized to assume any other warranty. Some States do not allow the exclusion or limitation of incidental or consequential damages or do not allow limitations on how long an implied warranty lasts, so the above limitations or exclusions may not apply to you. This warranty gives you specific legal rights, and you may also have other rights which vary from State to State.

*See turbocharger warranty for more info

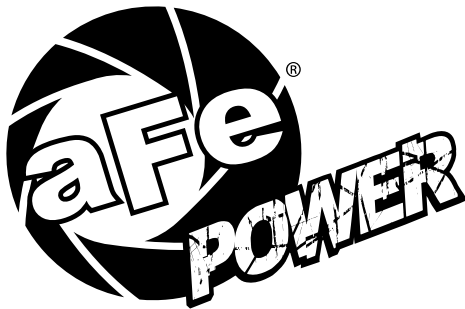

advanced FLOW engineering, inc.
252 Granite Street Corona, CA 92879
TEL: 951.493.7100