



INSTALLATION INSTRUCTIONS

MAKE: Honda
MODEL: Civic Si Coupe
YEAR: 2017-2020
ENGINE: L4-1.5L (t)

Cat-Back Exhaust

49-36620-B
 49-36620-P
 49-36620-L
 49-36620-C

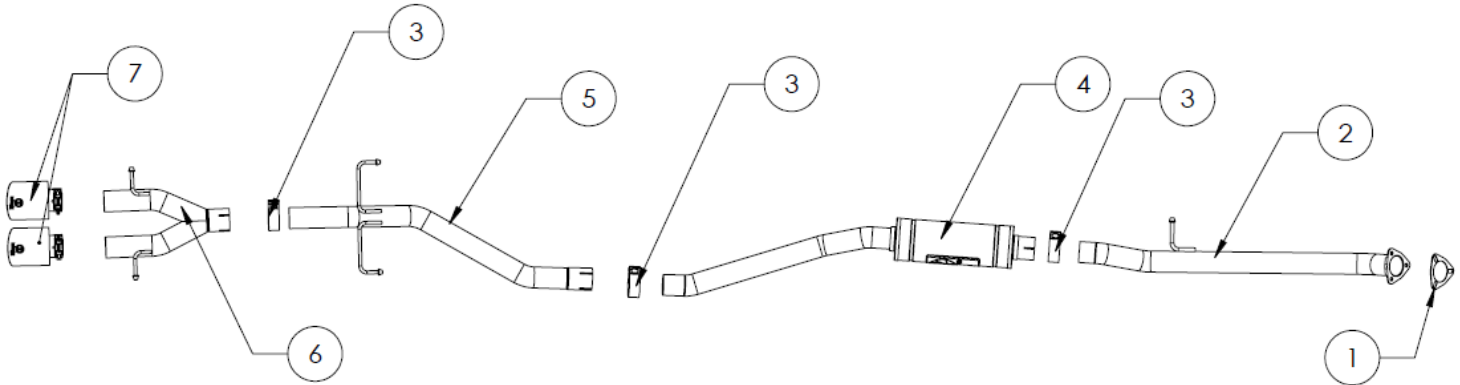

Item	Description	Part Number	Quantity
1	Gasket	05-46192	1
2	Mid-pipe 1	05-145891	1
3	2-1/2" Band Clamp	05-41061	3
4	Muffler Assembly	05-145892	1
5	Mid-pipe 2	05-145893	1
6	Tailpipe Assembly	05-145902	1
7	Clamp-on Polished Tip	49T25454-P07	2
	Clamp-on Black Tip	49T25454-B07	
	Clamp-on Blue Tip	49T25454-L07	
	Clamp-on Carbon Tip	49T25454-C07	

aFe POWER recommends professional installation on this product. Thoroughly inspect the aFe POWER exhaust system to make sure there is no damage from shipping (if damage is noted, immediately contact aFe POWER customer service). Allow time for your vehicle to cool down prior to installation. When working on your vehicle proceed with caution. Wear protective safety equipment; eye goggles and gloves to ensure a safe installation.

Install band clamps to proper torque specifications of 40-45 ft-lb.

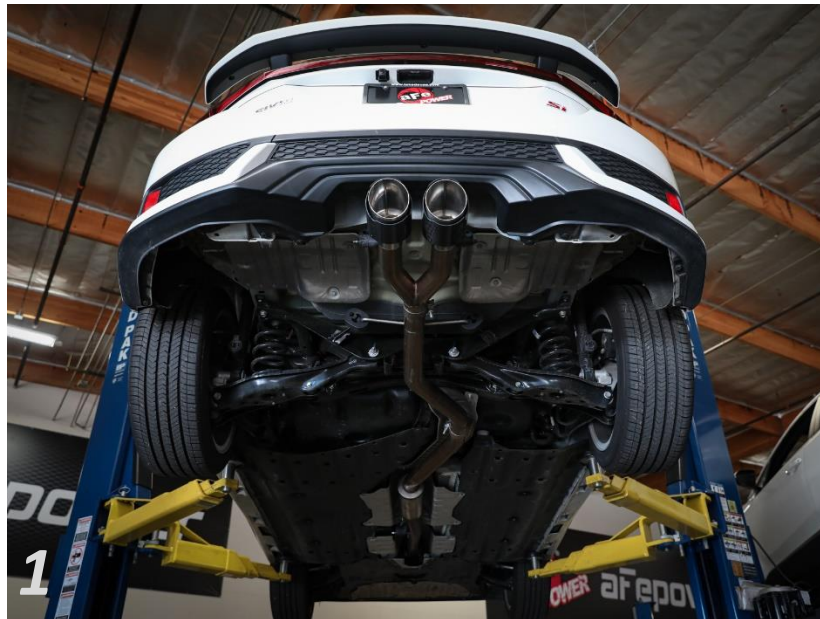



INSTALLATION INSTRUCTIONS

MAKE: Honda
MODEL: Civic Si Coupe
YEAR: 2017-2020
ENGINE: L4-1.5L (t)

Cat-Back Exhaust

49-36620-B
49-36620-P
49-36620-L
49-36620-C

1. **(Read instructions prior to installation.)** It is recommended to not fully tighten the exhaust until it has been fully installed. Leave loose for adjustability.
2. Secure vehicle on jack stands (refer to your manual for specified jack stand positions).
3. For faster installation, spread out the parts of the exhaust alongside your vehicle as shown in the diagram above.
4. Secure the stock exhaust with jack/stands.
5. Disconnect the negative battery terminal.
6. Remove the (x3) nuts securing the stock exhaust to the front pipe.
7. Remove the rubber hanger isolation mounts off the chassis and remove the stock exhaust.
8. Remove the rubber isolation mounts off the stock exhaust and transfer to the TAKEDA exhaust system.
9. Install the TAKEDA Mid-pipe 1 using OE nuts and (x1) supplied gasket.
10. Using the (x1) supplied 2.5" band clamp, install the TAKEDA Muffler Assembly to Mid-pipe 1.
11. Using the (x1) supplied 2.5" band clamp, install TAKEDA Mid-pipe 2 onto the Muffler Assembly.
12. Using the (x1) supplied 2.5" band clamp, install the TAKEDA Tailpipe Assembly onto the Mid-pipe 2.
13. Install the driver and passenger side clamp-on tips onto the Tailpipe Assembly using the supplied band clamps.
14. Ensure that all the components of the TAKEDA exhaust system are aligned and are at a safe clearance from all wires, hoses, brake lines, body parts, and tires.
15. Start from the front of the TAKEDA exhaust system and evenly tighten all clamps and fasteners.
16. Start the vehicle and check for any leaks. If any leaks are found, determine cause and repair as necessary.
17. Remove vehicle from jacks stands.
18. It is recommended to re-tighten all clamps and hardware after 50-100 miles.