

advanced FLOW engineering Momentum HD Cold Air Intake System

Instruction Manual P/N: 50-70051D / 50-70051T

Make: RAM

Model: 2500

Year: 2019-2020

Engine: L6-6.7L(td) Cummins

Make: RAM

Model: 3500

Year: 2019-2020

Engine: L6-6.7L(td) Cummins



- Please read the entire instruction manual before proceeding.
- Ensure all components listed are present.
- If you are missing any of the components, call customer support at 951-493-7185.
- Ensure you have all necessary tools before proceeding.
- Do not attempt to work on your vehicle when the engine is hot.
- Retain factory parts for future use.

| Label | Qty. | Description | Part Number |
|-------|------|--------------------------------------|--------------|
| A1 | 1 | Air Filter (Pro 10R) For 50-70051T | 20-91147 |
| A2 | 1 | Air Filter (Pro DRY S) For 50-70051D | 21-91147 |
| B | 1 | Tube | 05-5070051B1 |
| C | 1 | Housing | 05-5070051B2 |
| D | 1 | Coupling, Silicone Bellow Reducer | 05-01521 |
| E | 1 | Clamp, T-bolt (4-1/16" - 4-3/8") | 03-50262 |
| F | 1 | Clamp, T-bolt (4-5/16"-4-5/8") | 03-50499 |
| G | 1 | Clamp, T-bolt (8-5/16" - 8-5/8") | 03-50267 |
| H | 3 | Screw, Torx: M4 | 03-50490 |
| I | 1 | Plug Silicone | 05-01429 |

Installation will require the following tools:

8mm & 10mm nut drivers or ratchet and sockets, T20 torx bit or driver, pliers or flat-head screwdriver

Emissions Disclaimer: This product is not currently CARB exempt and is not available for purchase in California or for use on any vehicle registered with the California Department of Motor Vehicles.

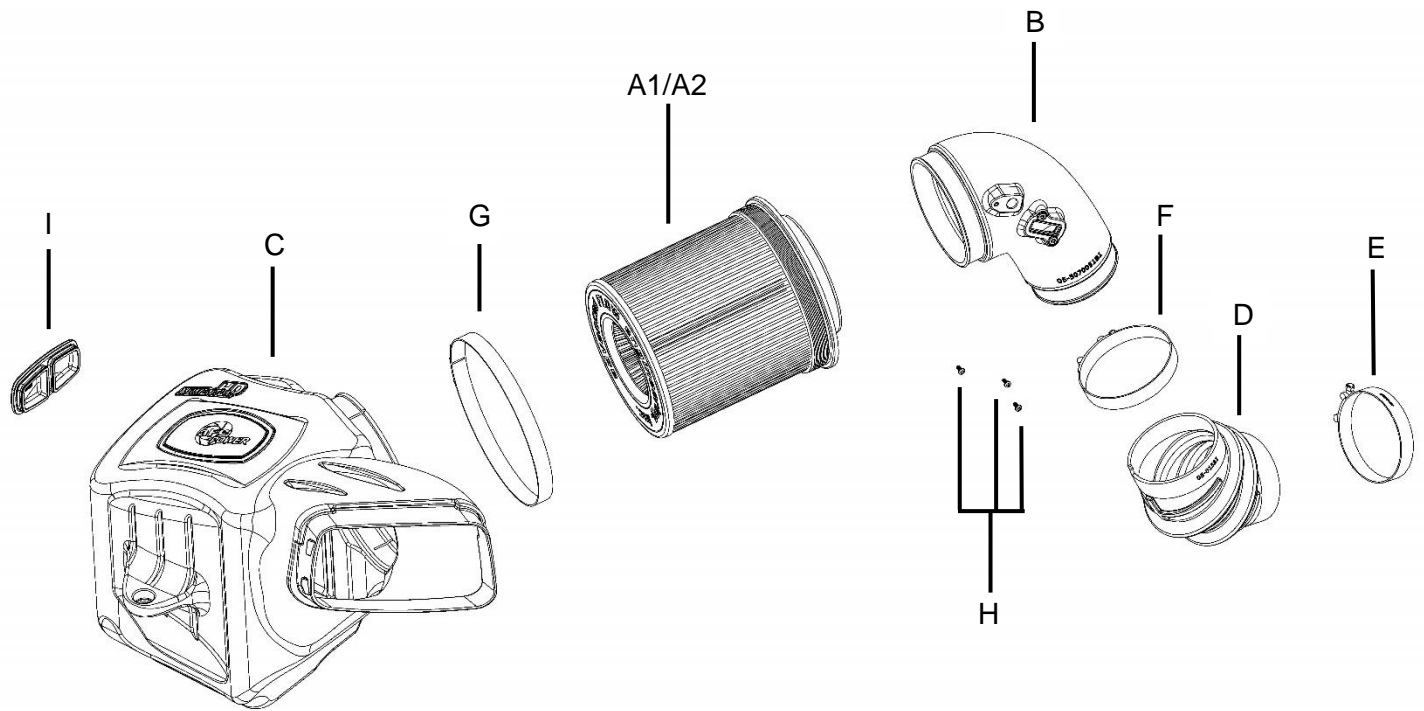

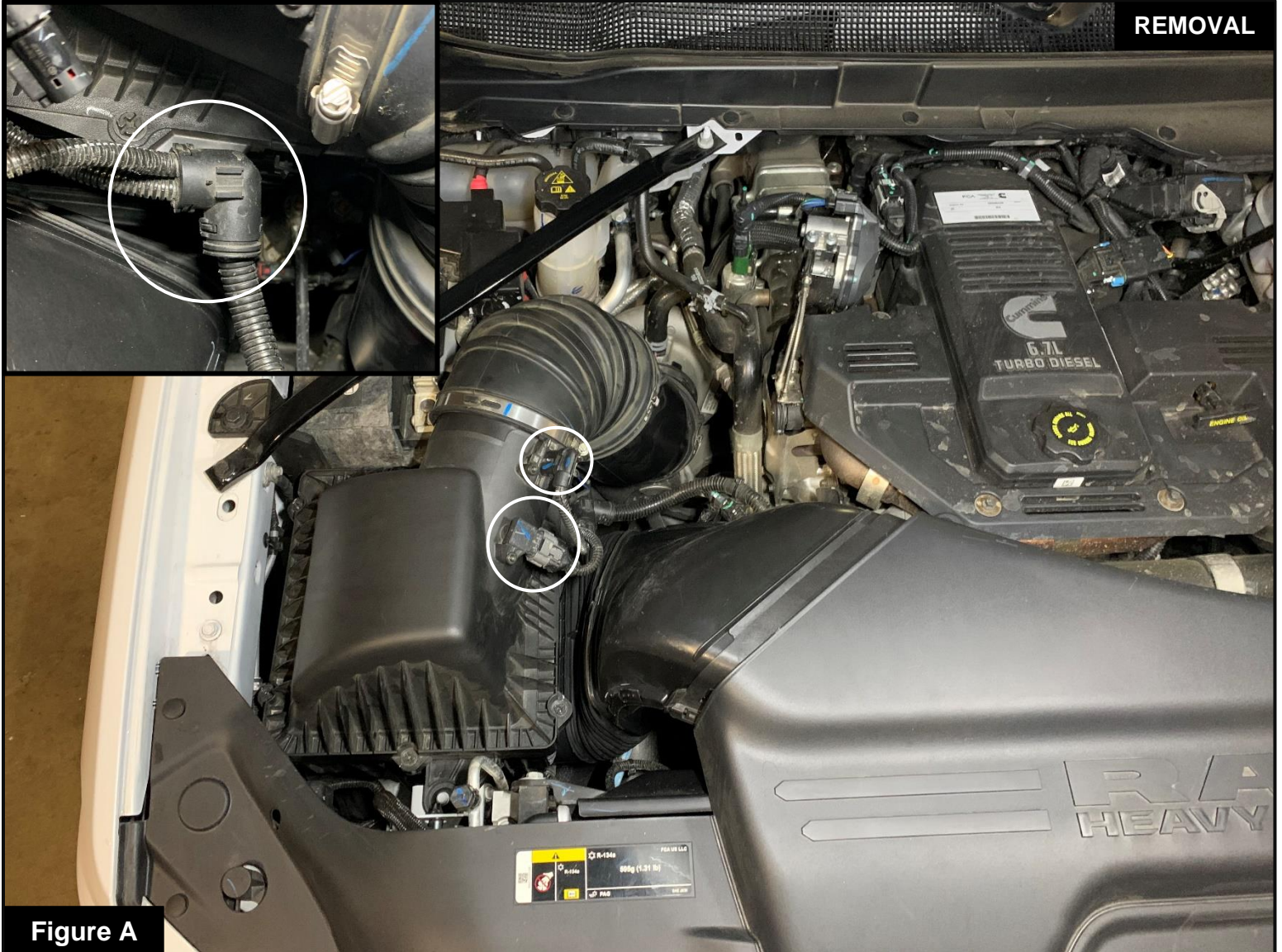
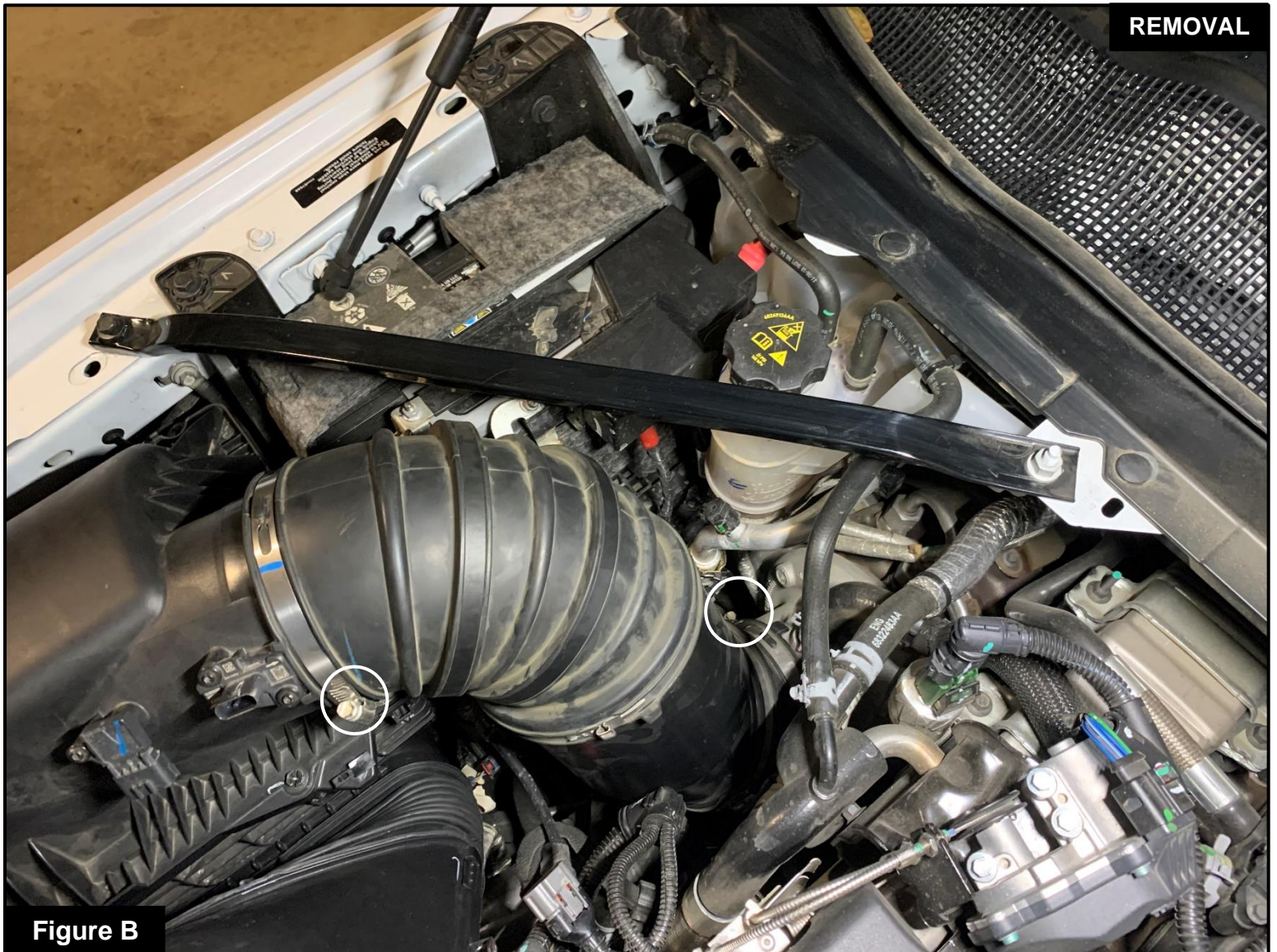

Figure A

Refer to Figure A for Steps 1-2

Step 1: After making sure your vehicle is completely off and in sleep mode, disconnect the Mass Air Flow (MAF) Sensor and Temperature sensor.

Step 2: Unclip the harness from the factory air box.



Refer to Figure B for Steps 3-4

Step 3: Untighten the clamps securing the factory tube to the air box and the turbo.

Step 4: Disconnect the tube from the factory air box, then from the turbo. Take the factory tube out of the vehicle.

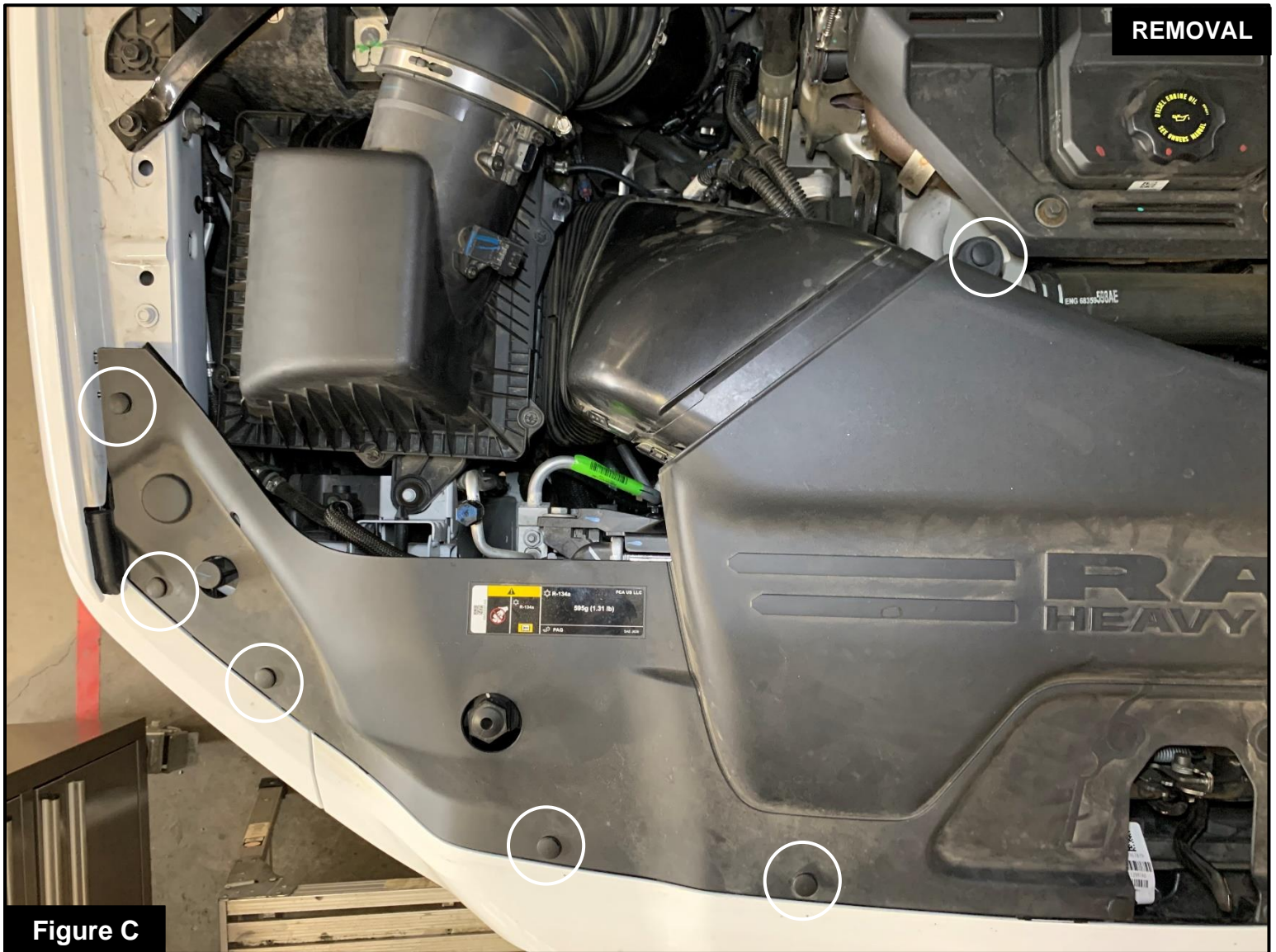

Figure C

Refer to Figure C for Step 5

Step 5: Using a flat head screw driver, or panel popper, remove the plastic rivets securing the front cover (circled).

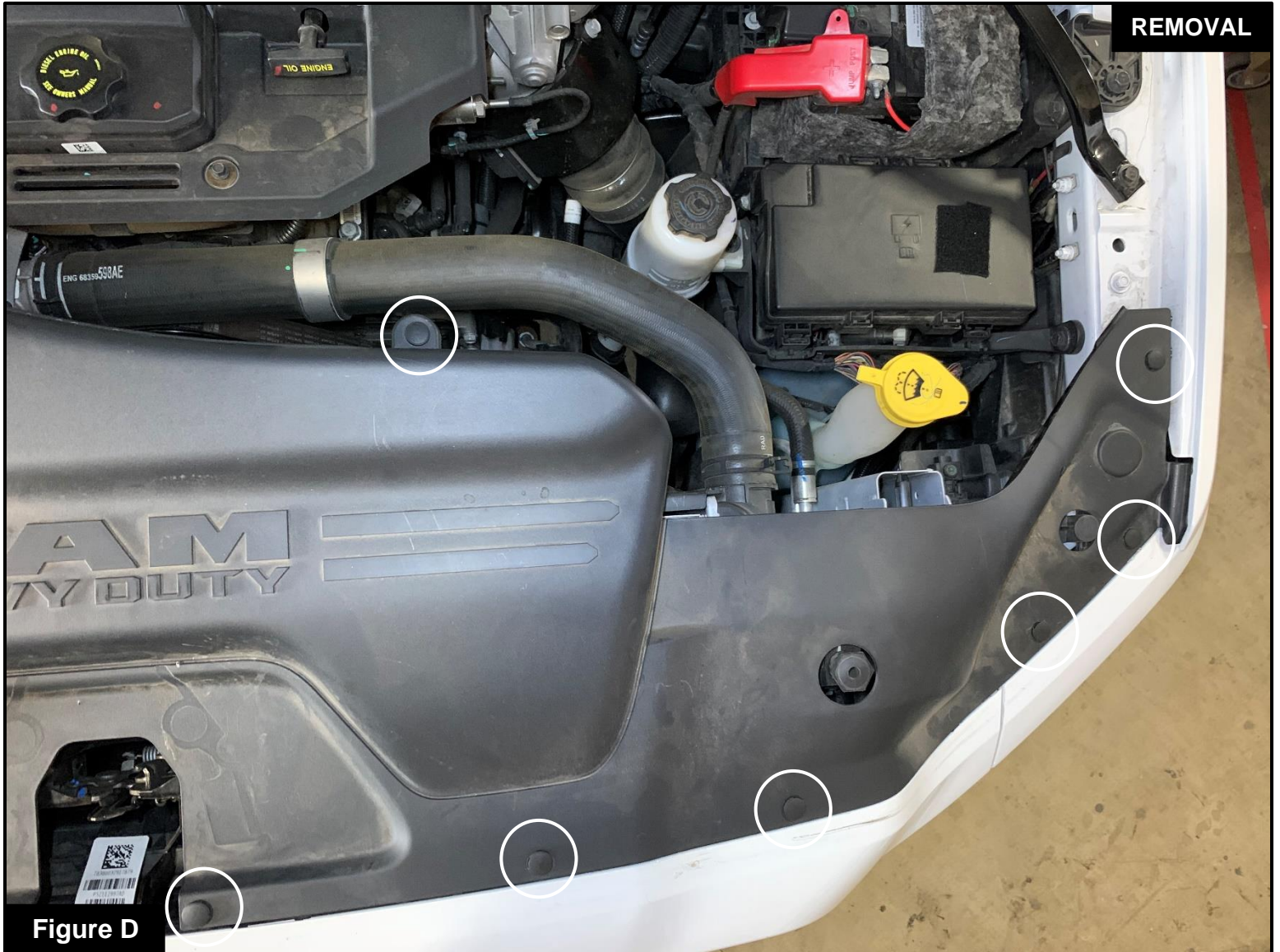
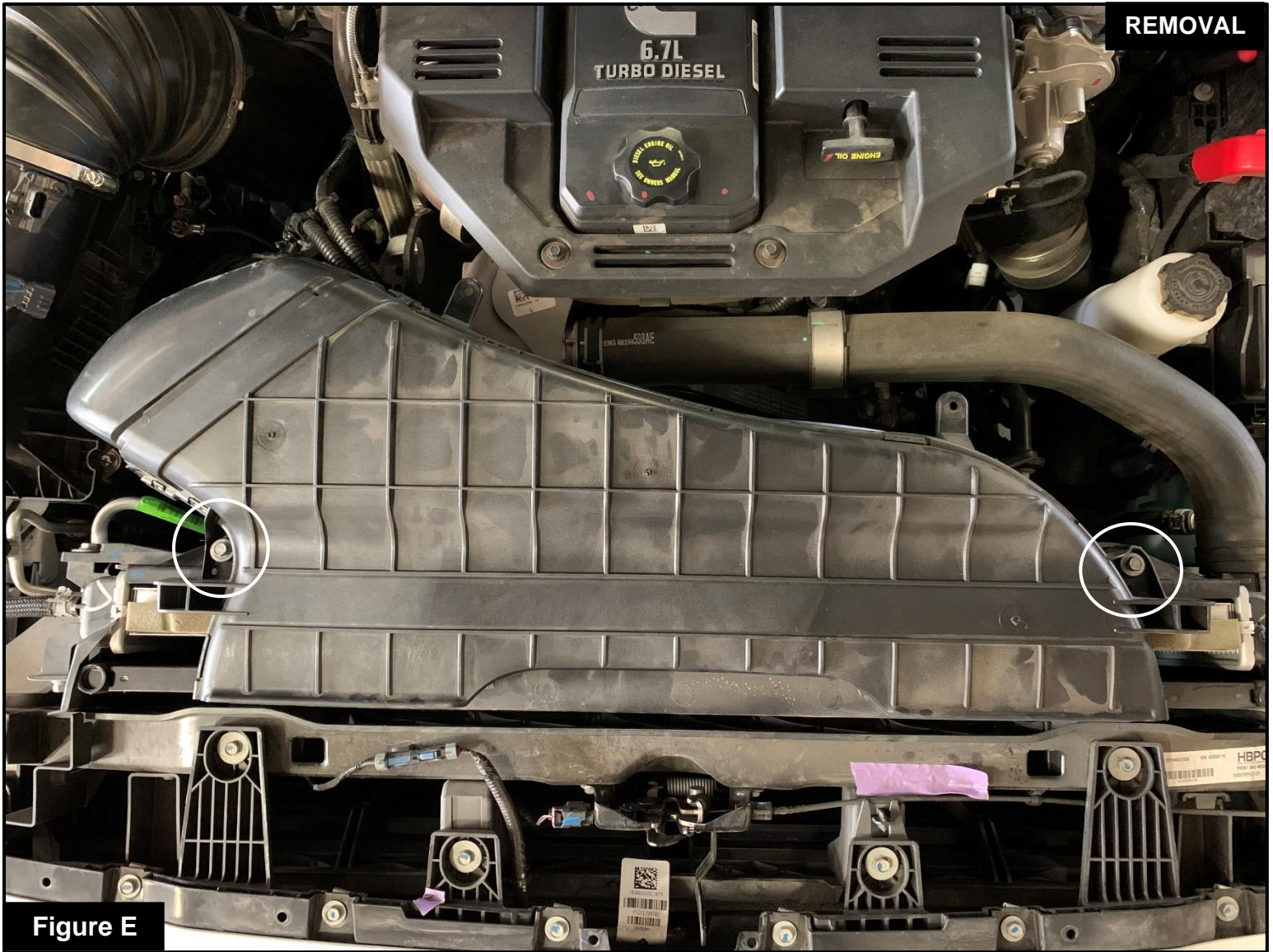

Figure D

Refer to Figure D for Steps 6-7

Step 6: Remove all plastic rivets securing the front cover (circled).

Step 7: Remove the front cover out of the vehicle to get access to the air inlet scoop.



Refer to Figure E for Steps 8-9

- Step 8: Remove the two screws (circled) securing the factory air intake scoop. These screws will be re-used.
- Step 9: Pull the factory air box out of its mounting pegs, then carefully pull the factory airbox and scoop together out of the vehicle.



Figure F

Refer to Figure F for Step 10

Step 10: Transfer the three factory grommets from the factory air box to the aFe POWER housing.

**Figure G****Refer to Figure G for Steps 11-14**

- Step 11: Remove the factory scoop from the factory air box and connect it to the aFe POWER housing.
- Step 12: Slide the aFe POWER air filter into the housing.
- Step 13: Install the larger clamp on the aFe POWER housing and tighten it to secure the air filter.
- Step 14: Place the clamp supplied with the aFe POWER air filter over its flange. Do not tighten at this time.

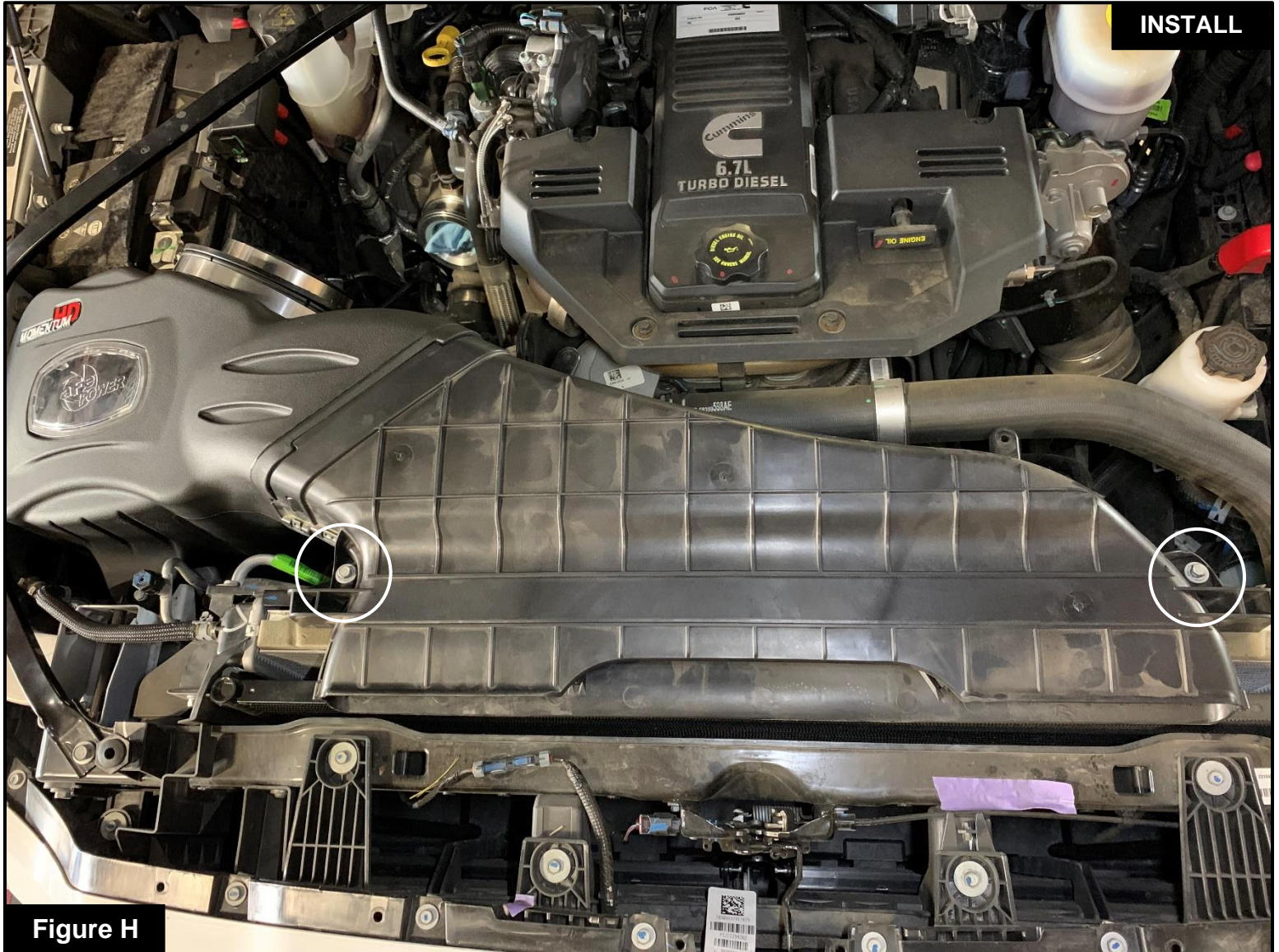

Refer to Figure H for Steps 15-16

Step 15: Install the aFe POWER housing and factory scoop assembly into the vehicle. Press the housing into the mounting pegs.

Step 16: Secure the scoop using the two factory screws removed at step 8.

**Figure I****Refer to Figure I for Step 17**

Step 17: Transfer the MAF sensor and Temperature sensor from the factory air box to the aFe POWER tube. Secure them using the provided Torx Screws.

**Figure J****Refer to Figure J for Steps 18-19**

Step 18: Install the coupling onto the aFe POWER tube. Line up the notch on the coupling with the tube.

Step 19: Install the provided clamps over the coupling. Place the larger of the two to join the coupling and aFe POWER tube. Tighten the clamp on the tube side but do not tighten the clamp on the other end yet.



Figure K

Refer to Figure K for Steps 20-21

Step 20: Install the aFe POWER tube assembly over the turbo, then into the air filter.

Step 21: Align the tube correctly, then tighten all clamps.



Figure L

Refer to Figure L for Step 22

Step 22: Reconnect the MAF and Temperature sensors harnesses.

 **Make sure that the connections are fully engaged. Usually, connectors make a snapping sound when fully engaged.**



Figure M

Refer to Figure M for Step 23

Step 23: The kit includes an optional plug to close off the side auxiliary air inlet. Install the plug if you wish to close off the side auxiliary air inlet and only capture cold air from the front.

- Without the plug installed, the Momentum air intake will capture the maximum air available. More airflow offers more power. Yet some of this air is picked up from inside the engine compartment and could be warmer air. Warmer air will affect the performance of the vehicle.
- The plug installed on the housing will block off any hot engine air entering the housing and make sure the coolest air available is directed into the engine. It will also reduce the noise of the intake.



Figure N

Refer to Figure N for Steps 24-25

Step 24: Re-install the factory front cover and secure it with the plastic rivets removed at steps 5 and 6.

Step 25: Verify all clamps and connections are secured. Your installation is now complete. Thank you for choosing aFe POWER!

NOTE: Check all screws, clamps, and connectors are secure after 100-200 miles.



Pro DRY S Air Filter

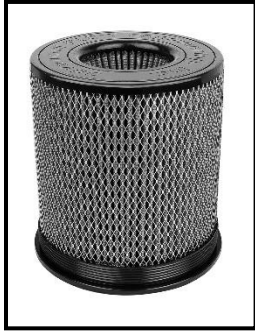

P/N: 21-91147

Pro 5R Air Filter



P/N: 24-91147

Pro 10R Air Filter



P/N: 20-91147

Pre-Filter



P/N: 28-10273

Pro Dry S Restore Kit



P/N: 90-50501

Pro 5R Restore Kit



P/N: 40-33205-B

Flashlight LED



P/N: 40-10202

Mechanic Gloves (L)



P/N: 40-10149

To purchase any of the items above, view airflow charts, dyno graphs, photos, and video; please go to aFepower.com.



Warranty

General Terms:

- aFe warrants their products to be free from manufacturer's defects due to workmanship and material.
- This warranty applies only to the original purchaser of the product and is non-transferrable.
- Proof of purchase of the aFe product is required for all warranty claims.
- Warranty is valid provided aFe instructions for installation and/or cleaning were properly followed.
- Proper maintenance with regular inspections of product is required to insure warranty coverage.
- Damage due to improper installation, abuse, unauthorized repair or alteration is not warranted.
- Incidental or consequential damages or cost, including installation and removal of part, incurred due to failure of aFe product is not covered under this warranty.
- All warranty is limited to the repair and/or replacement of the aFe part. To request Return Goods Authorization ("RGA"), email RGA@afepower.com or call (951)493-7100. Upon receipt of the RGA, you must return the product to the address provided in the RGA, freight prepaid and accompanied with a dated proof of purchase and the RGA. Upon receipt of the defective product and upon verification of proof of purchase, aFe will either repair or replace the defective product within a reasonable time, not to exceed thirty days.

| Product Category | P/N Prefix | Warranty duration |
|----------------------------------|--|---------------------|
| Direct OE Replacement Filters | 10, 11, 30, 31, 71, 73 | Life of the vehicle |
| Racing Filters | 18 | 1 year |
| Universal | 20, 21, 23, 24, 72, TF | 2 years |
| Air Intake Systems | 50, 51, 53, 54, 55, 56, 57, 58, 75, TR, TA, TL, TM | 2 years |
| Exhaust Systems | 49 | 2 years |
| Intercoolers & Intercooler Tubes | 46-2 | 2 years |
| Intake Manifolds | 46-1 | 2 years |
| Differential Cover | 46-7 | Life of the vehicle |
| Exhaust Manifolds | 46 | 2 years |
| Throttle Body Spacers | 46-3 | 2 years |
| Turbochargers | 46-6 | 2 years* |
| Fluid Filters | 44 | 90 days |
| Pre-Filters | 28 | 2 years |
| Heavy Duty OE Replacement | 70 | 2 years |
| PowerSports OE Replacement | 81, 87 | 2 years |
| PowerSports Intake Systems | 85 | 2 years |

No other warranty expressed or implied applies nor is any person or advanced FLOW engineering authorized to assume any other warranty. Some States do not allow the exclusion or limitation of incidental or consequential damages or do not allow limitations on how long an implied warranty lasts, so the above limitations or exclusions may not apply to you. This warranty gives you specific legal rights, and you may also have other rights which vary from State to State.

*See turbocharger warranty for more info

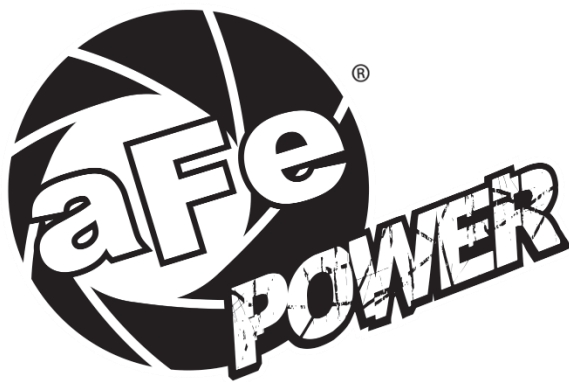

advanced FLOW engineering, inc.

252 Granite Street Corona, CA 92879
TEL: 951.493.7100 • TECH: 951.493.7185
E-Mail: Tech@aFepower.com

P/N: 06-81320