

**advanced FLOW engineering** Quantum Air Intake

**Instruction Manual** P/N: 53-10016D / 53-10016R

Make: **Ford** Model: **F-250/F-350/F-450/F-550** Year: **2008-2010** Engine: **V8-6.4L (td) Power Stroke**



- Please read the entire instruction manual before proceeding.
- Ensure all components listed are present.
- If you are missing any of the components, call customer support at 951-493-7100.
- Ensure you have all necessary tools before proceeding.
- Do not attempt to work on your vehicle when the engine is hot.
- Disconnect the negative battery terminal before proceeding.
- Retain factory parts for future use.

Label	Qty.	Description	Part Number
A1	1	Air Filter (Pro DRY S)	21-90098
A2	1	Air Filter (Pro 5R)	23-91129
B	1	Tube	05-5310016B1
C	1	Housing	05-5310016B2
D	1	Coupling, Silicone Bellow	05-01457
E	1	Coupling, Silicone Reducer	05-01505
F	2	Screw, Torx: M4	03-50490
G	1	Clamp, #048	03-50007
H	1	Clamp, #052	03-50008
I	1	Clamp, #072	03-50010
J	1	Clamp, #080	03-50011
K	1	Grommet	03-50139
L	1	Fitting, Vent Tube	03-50178
M	1	Clamp, Mini	03-50023

**Installation will require the following tools:**

8mm nut driver, T-20 Torx, Phillips #3 screwdriver and flat head screwdriver.

**Emissions Disclaimer:** This product is not currently CARB exempt and is not available for purchase in California or for use on any vehicle registered with the California Department of Motor Vehicles.

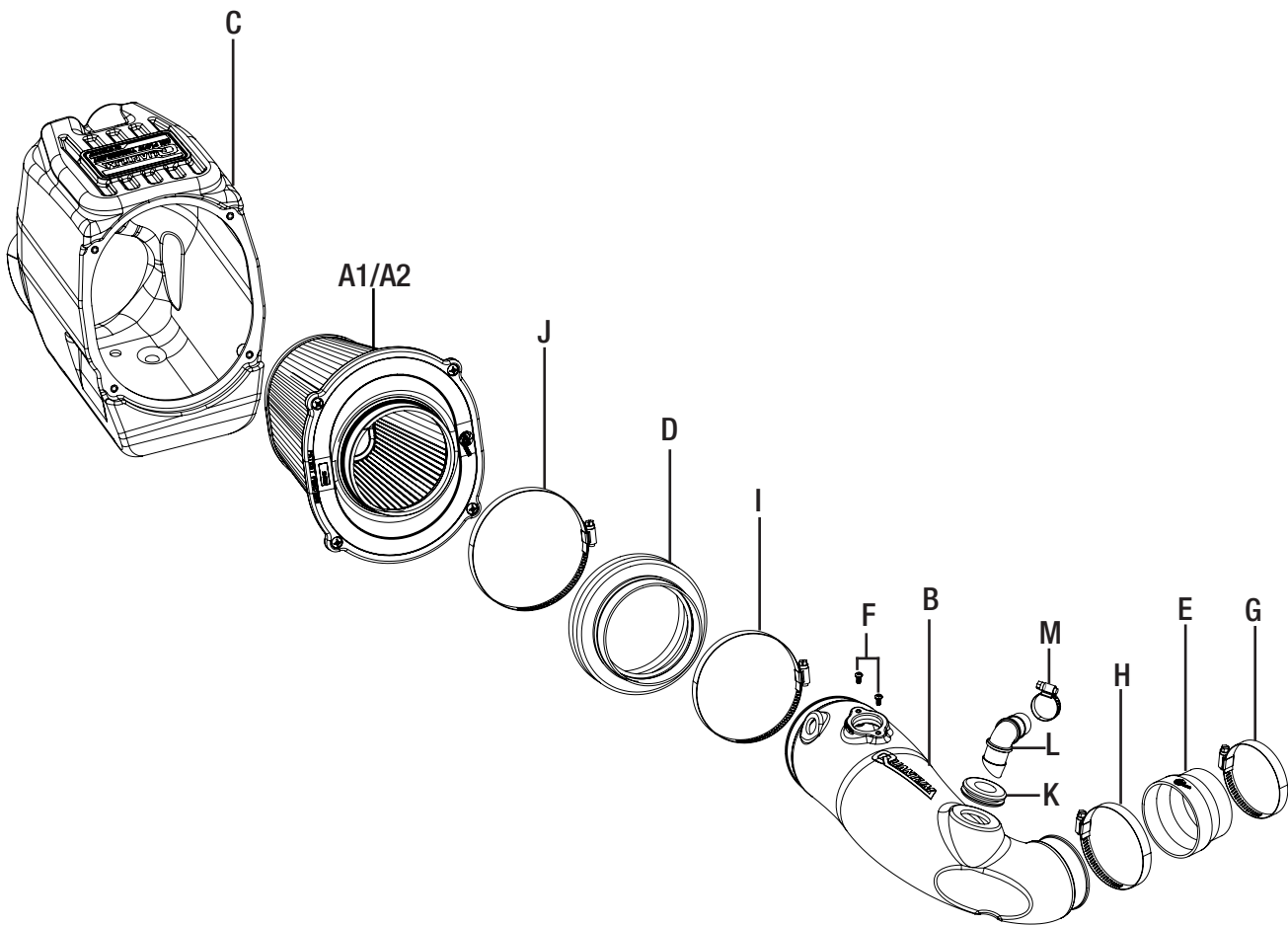

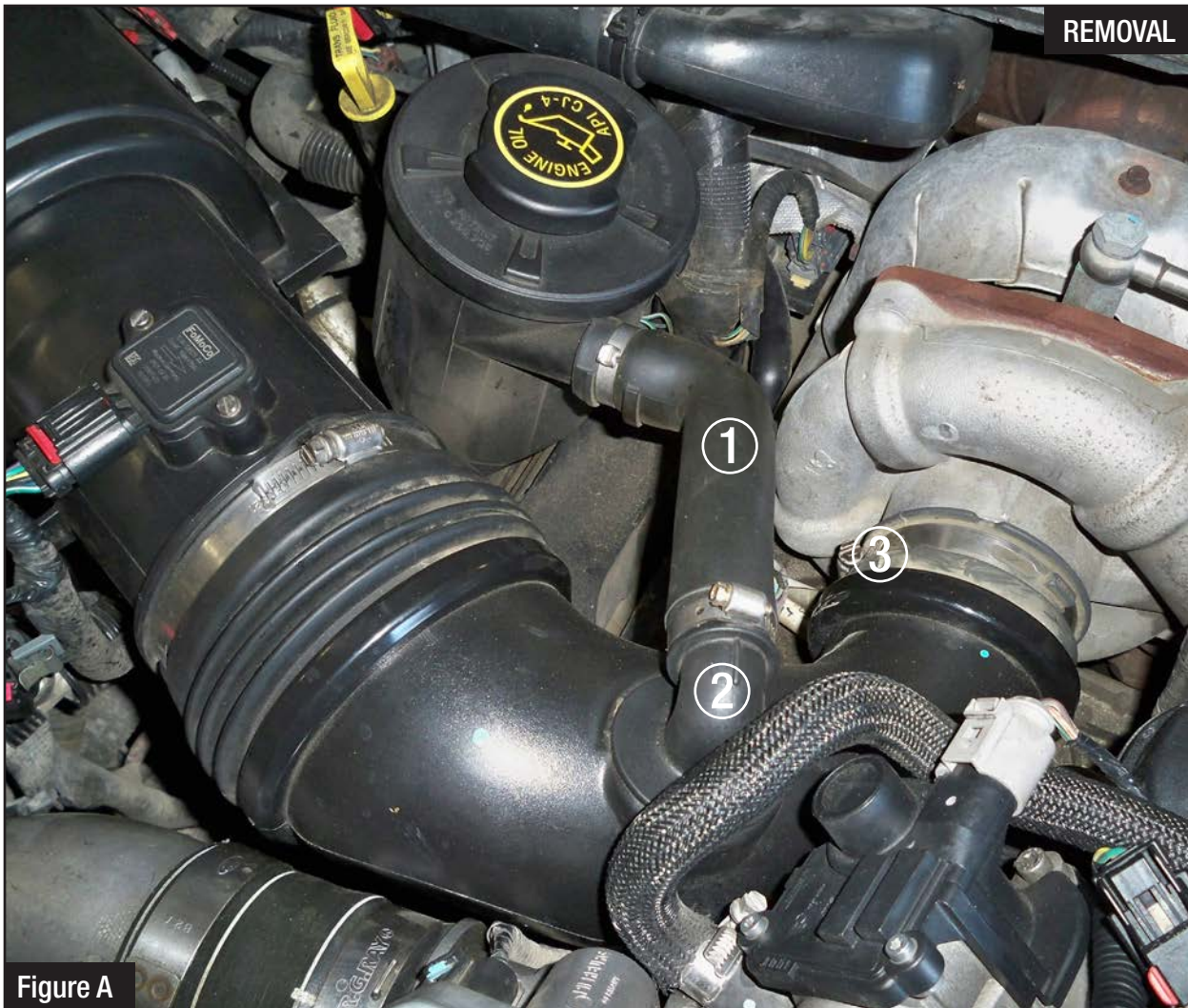
**Refer to Figure A for Steps 1-2**

Step 1: Disconnect the crankcase vent oil separator hose (1) from the intake fitting (2) by prying the clamp open with a flat head screwdriver and discard the clamp.

Step 2: Using an 8mm nut driver, loosen the clamp (3) at the turbo.

**Figure B****Refer to Figure B for Steps 3-5**

Step 3: Disconnect the filter minder (4) and the Mass Air Flow (MAF) sensor (5) connectors.

Step 4: Unclip the two latches (6) from the upper section of the housing.

Step 5: Remove the upper section of the housing.



**Refer to Figure C for Steps 6-8**

Step 6: Remove the air filter (7).

Step 7: Remove the intake tube assembly (8).

Step 8: Pull up on the lower section of the housing (9) to remove it from the support bracket grommets.



Figure D

### **Refer to Figure D for Steps 9-10**

Step 9: Slide the aFe POWER filter into the aFe POWER housing. Install the aFe POWER filter using a #3 Phillips screwdriver. Tighten all four screws.

Step 10: Install the supplied bellows coupling (10) onto the air filter using the supplied #80 clamp (11). Tighten the clamp.

**Figure E****Refer to Figure E for Steps 11-13**

Step 11: Remove the filter minder and grommet (12) from the factory intake tube assembly and install them onto the aFe POWER intake tube.

Step 12: Using a T20 Torx driver, remove the MAF sensor (13) from the factory intake tube assembly and install it onto the aFe POWER intake tube using the two supplied M4 screws.

Step 13: Install the supplied rubber grommet and vent fitting (14) onto the aFe POWER intake tube.





### Refer to Figure F for Step 14

Step 14: Install the aFe POWER housing assembly (15) into the vehicle while inserting the vent hose (16) into the aFe POWER housing assembly. Make sure the housing pins go into the mounting bracket grommets.

**Figure G****Refer to Figure G for Steps 15-16**

Step 15: Install the supplied silicone reducer coupling (17) onto the aFe POWER intake tube with the supplied #52 clamp (18). Tighten the clamp.

Step 16: Place the provided #48 clamp (19) onto the reducer coupling and the #72 (20) clamp onto the filter coupling.

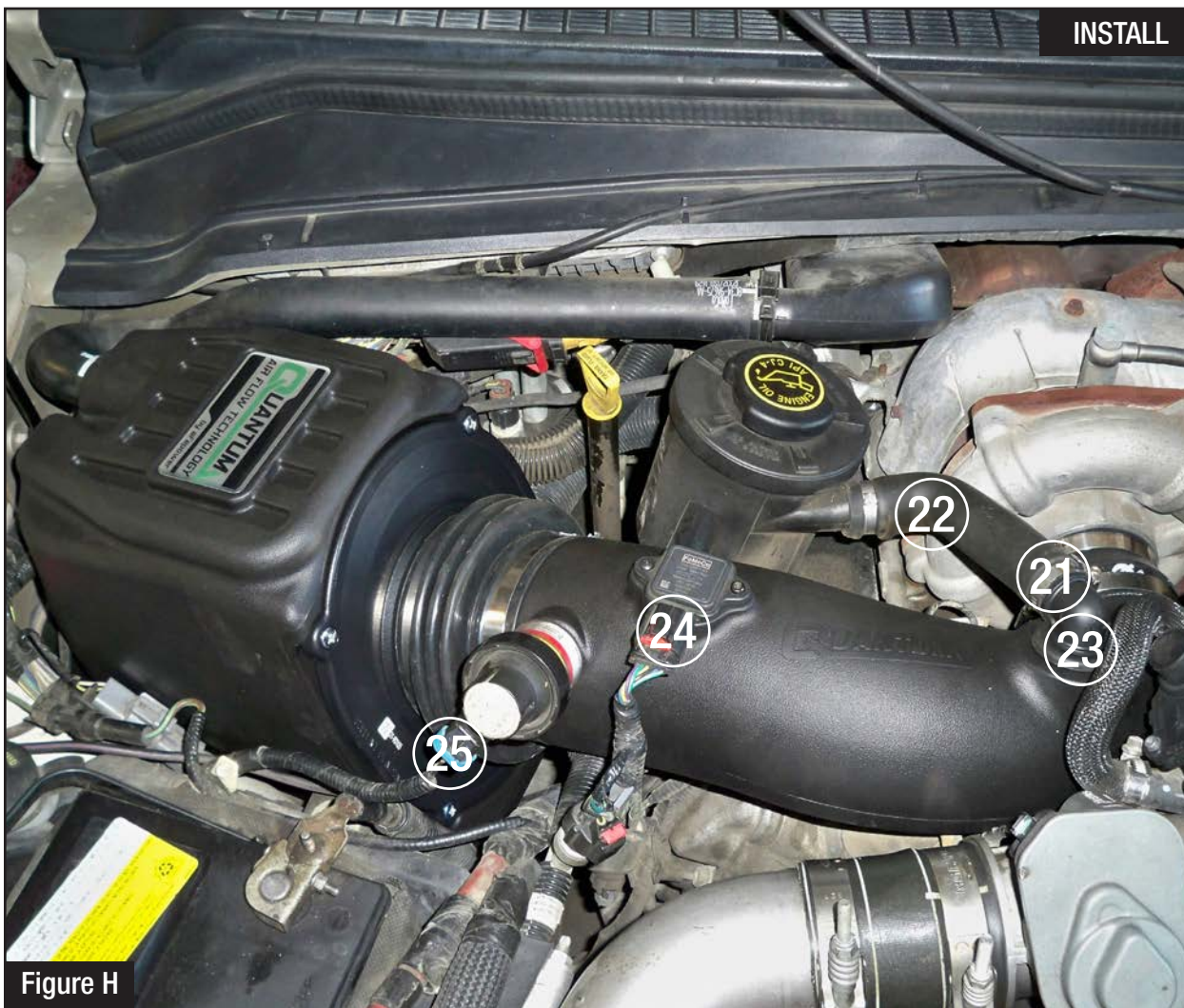

Figure H

### **Refer to Figure H for Steps 17-20**

Step 17: Slide the aFe POWER intake tube into the turbo inlet, then into the coupling at the filter. Tighten all the clamps with an 8mm nut driver.

Step 18: Slide the supplied mini clamp (21) onto the crankcase vent hose.

Step 19: Install the crankcase vent hose (22) into the vent fitting (23) and secure it with the mini clamp.

Step 20: Reconnect the MAF sensor (24) and the filter minder (25). Check all the components are tight and secure. Your installation is now complete. Thank you for choosing aFe POWER!

**NOTE: Check all clamps and connectors after 100-200 miles.**



Page left blank intentionally

Page left blank intentionally

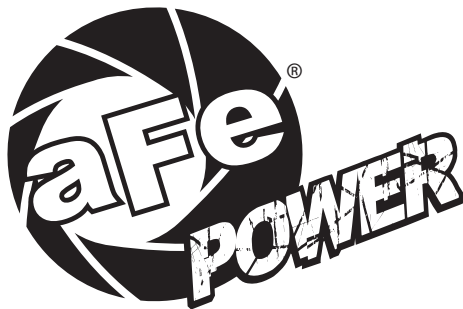

**advanced FLOW engineering, inc.**  
252 Granite Street Corona, CA 92879  
TEL: 951.493.7100 • TECH: 951.493.7134  
E-Mail: [Tech@aFepower.com](mailto:Tech@aFepower.com)