

**STAGE-2** **Si**

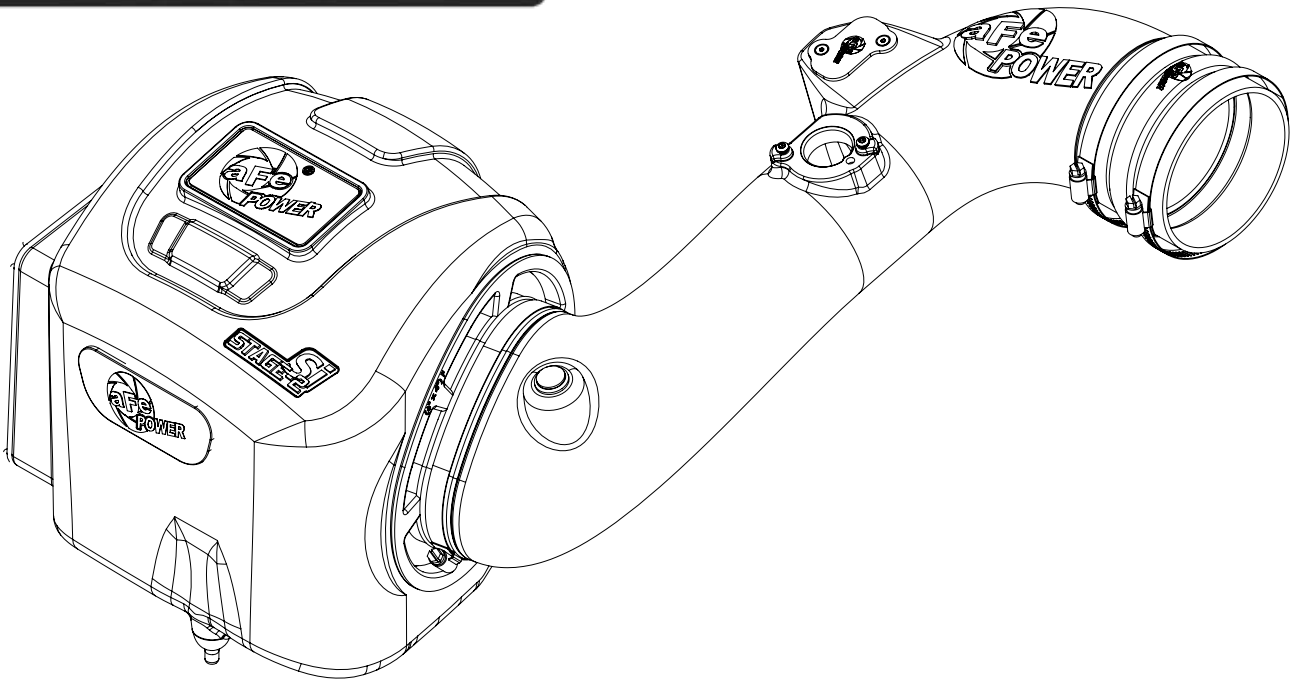

## advanced FLOW engineering

Magnum FORCE Stage-2 Si Air Intake System

**Instruction Manual** P/N: 54-82322-1

Make: **Chevrolet** Model: **Silverado HD** Year: **2011-2016** Engine: **V8-6.6L Duramax LML**  
Make: **GMC** Model: **Sierra HD** Year: **2011-2016** Engine: **V8-6.6L Duramax LML**  
Note: **Includes Denali Trim.**



- Please read the entire instruction manual before proceeding.
- Ensure all components listed are present.
- If you are missing any of the components, call customer support at 951-493-7100 or e-mail at tech@afepower.com.
- Ensure you have all necessary tools before proceeding.
- Do not attempt to work on your vehicle when the engine is hot.
- Disconnect the negative battery terminal before proceeding.
- Retain factory parts for future use.

Label	Qty.	Description	Part Number
A	1	Air Filter (Pro 5R)	24-91136
B	1	Tube	05-82322B1
C	1	Housing	05-82322B3
D	1	Seal, Trim: 7/16" (27"L)	05-00072
E	1	Plug, Airbox	05-00937
F	1	Grommet	03-50033
G	1	Cap	03-50103
H	4	Screw, Torx: M4	03-50491
I	2	Screw, M4x12mm	03-50455
J	1	Sensor Cover	05-01372
K	1	Gasket	05-00631
L	2	Clamp, #072	03-50010
M	1	Coupling, Silicone Hump	05-01201

**Installation will require the following tools:**

8mm Nut driver, 10mm Nut driver, Torx (T-20) driver, and 2.5mm Allen.

Warranty Information available at: <https://afepower.com/contact#warranty>

Note: Legal in California for use on race vehicles only. The use of this device on vehicles used on public streets or highways is strictly prohibited in California and others states that have adopted California emission regulations.

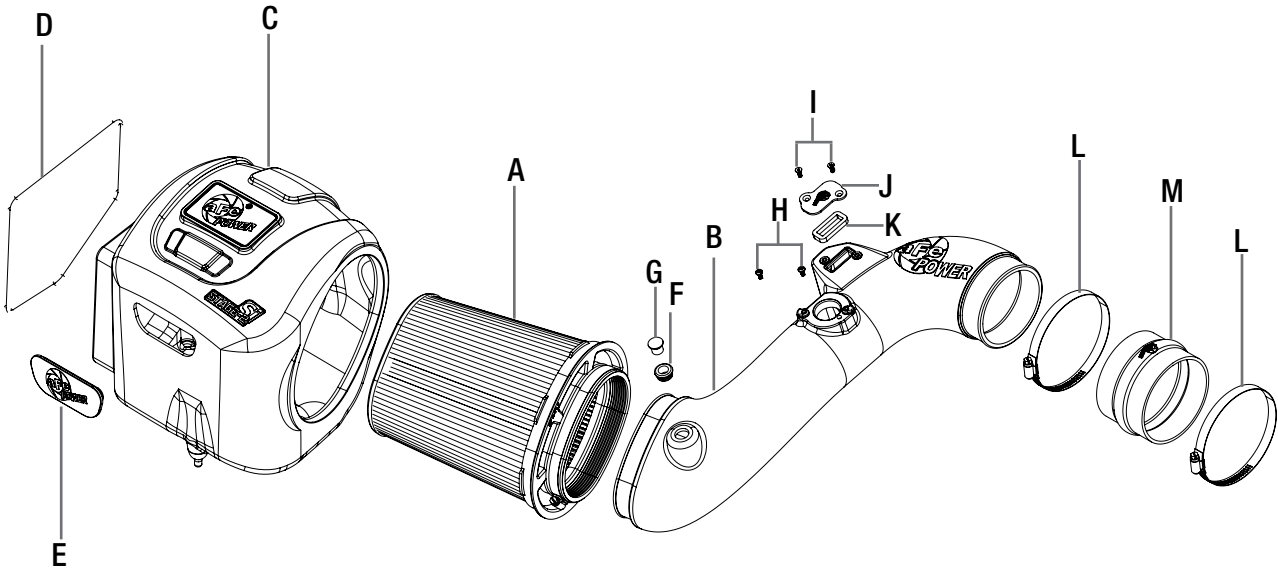



**Refer to Figure A for Steps 1-2**

Step 1: On 2015-2016 vehicles, remove the plastic trim (1). Remove the sight shield (2) by removing all twelve shield clips. Remove the diagonal brace (3) with a 10mm socket and ratchet.

Step 2: Disconnect the Mass Air Flow sensor (4) and Humidity sensor (5) (if equipped).

**Refer to Figure B for Steps 3-5**

Step 3: Using an 8mm nut driver, loosen the clamps (6) from the intake tube.

Step 4: Remove the factory intake tube (7).

Step 5: Remove the factory airbox (8) out of the vehicle. (Use an upward pull to release the retaining plug).

**Figure C****Refer to Figure C for Steps 6-7**

Step 6: Remove the retaining plug (9) from the bottom of the factory airbox and transfer it to the aFe housing.

Step 7: Install the supplied trim seal (10) on the opening of the aFe housing.



Figure D

**Refer to Figure D for Steps 8-9**

Step 8: Slide the aFe filter into the aFe housing.

Step 9: Use the provided plug (11) to close the additional air inlet if you want to completely seal the housing.

**Note:** Best performance gain is obtained by having more air flow (No plug). However, having the plug installed will lower engine noise coming from the housing.



**Refer to Figure E for Step 10**

Step 10: Install the aFe housing assembly (12) into the vehicle. Firmly push it into the factory mounting grommets.





Figure F

2011 Model Shown.

### Refer to Figure F for Steps 10-12

Step 10: Remove the filter minder and grommet (13) from factory airbox (if equipped). Install the grommet into the aFe elbow tube and then push in the filter minder.

**Note: If you choose not to use the filter minder or your vehicle is not equipped with one, just plug off the hole with the supplied grommet and cap (14).**

Step 11: Using a T-20 Torx driver, remove the MAF sensor (15) and Humidity sensor (if equipped) from the factory airbox.

Step 12: Install the MAF sensor and Humidity sensor into the aFe intake tube using the provided M4 screws and a T-20 Torx driver.

**Note: If the vehicle does NOT have a Humidity sensor, use the supplied gasket, M4 x 12mm flathead screws, and cover (16) to seal the opening.**

**Figure G****2011 Model Shown.****Refer to Figure G for Steps 13-14**

Step 13: Install the the supplied hump coupling (17) and #072 clamps (18) over the turbo inlet.

Step 14: Install the aFe intake tube by sliding the it into the hump coupling first and then into the air filter.  
Tighten all the clamps with an 8mm nut driver.



Figure H

2011 Model Shown.

### **Refer to Figure H for Steps 15-17**

Step 15: Reconnect the MAF sensor (19) and the Humidity sensor (if equipped).

Step 16: On 2015-2016 models, reinstall the diagonal brace, the sight shield (with 12 clips) and the plastic trim.

Step 17: Check all the components are tight and secure. Your installation is now complete. Thank you for choosing aFe POWER!

**NOTE: Check all bolts, clamps, and connectors after 100-200 miles.**

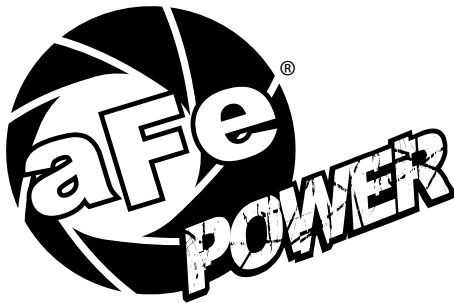

**advanced FLOW engineering, inc.**  
252 Granite Street Corona, CA 92879  
TEL: 951.493.7100 • TECH: 951.493.7134  
E-Mail: [Tech@aFepower.com](mailto:Tech@aFepower.com)