

advanced FLOW engineering

Instruction Manual P/N: TM-1018P-D / TM-1018P-R



Make: **Honda**
Make: **Acura**

Model: **Civic Si (Coupe/Sedan)** Year: **2012-2015** Engine: **L4-2.4L**
Model: **ILX** Year: **2013-2015** Engine: **L4-2.4L**



- Please read the entire instruction manual before proceeding.
- Ensure all components listed are present.
- If you are missing any of the components, call customer support at 951-493-7100.
- Ensure you have all necessary tools before proceeding.
- Do not attempt to work on your vehicle when the engine is hot.
- Disconnect the negative battery terminal before proceeding.
- Retain factory parts for future use.

Label	Qty.	Description	Part Number
A1	1	Air Filter (Pro DRY S)	TF-9019D (Grey Media) TM-1018P-D
A2	1	Air Filter (Pro 5R)	TF-9019R (Blue Media) TM-1018P-R
B	1	Tube	05-T1018P1
C	1	Housing	05-T1018B2
D	2	Clamp, #044	03-50019
E	1	Coupling Silicone	05-01196
F	1	Hose, 3/8" ID (8.5" inch)	05-01503
G	1	Hose, 5/8" ID (8" inch)	05-01502
H	1	Clamp, #096	03-50003

Installation will require the following tools:

Phillips screw driver, 8mm nut driver, ratchet, extension, 10mm socket & pliers

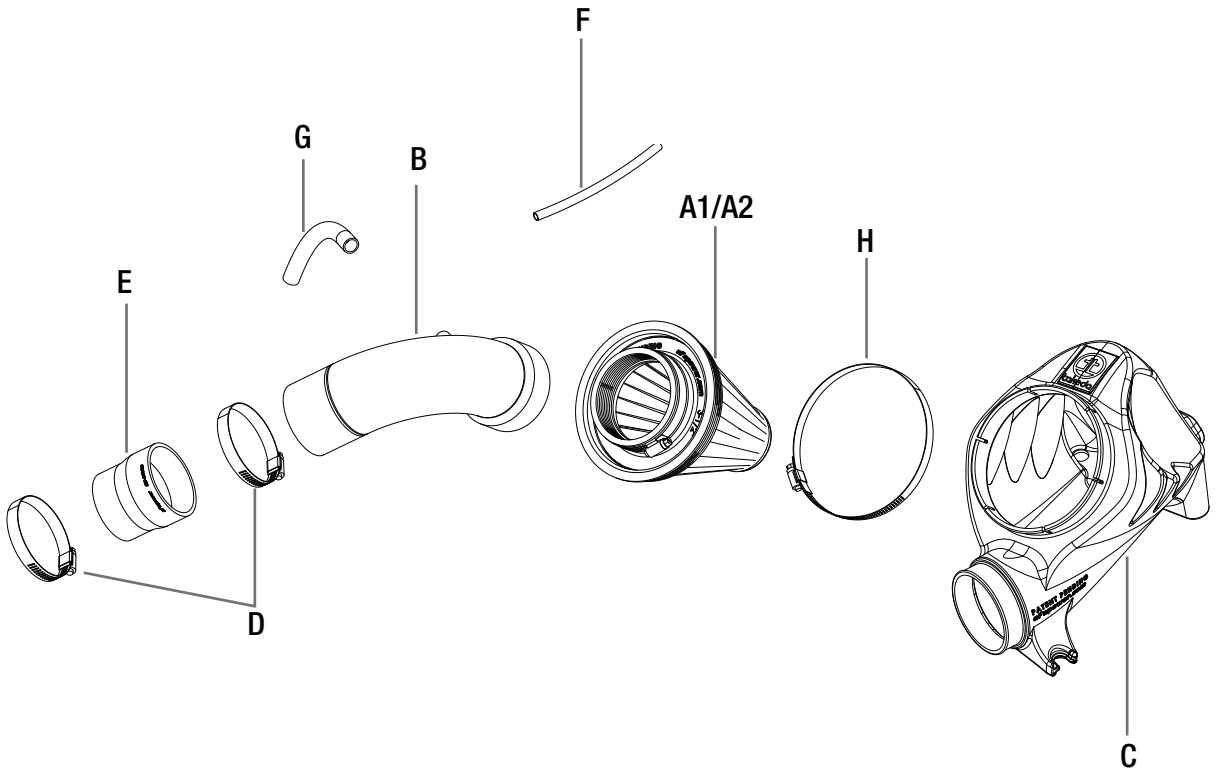

**Figure A****Refer to Figure A for Steps 1-4**

Step 1: Loosen the clamp at the throttle body with a 10mm socket (1).

Step 2: Unplug the MAF sensor, remove the clip holding the MAF sensor harness to the housing (2).

Step 3: Remove the crankcase breather from the factory tube (3).

Step 4: Unclip the two (x2) clips off factory airbox housing and remove top part of factory housing along with tube out of vehicle (4).



Figure B

Refer to Figure B for Steps 5-8

Step 5: Remove the lower factory housing mount with a 10mm socket and extension (5).

Step 6: Pull the bottom part of the factory housing off the rubber mounting grommets and remove out of the vehicle.

Step 7: Pull the factory air duct out of the vehicle (6).

Step 8: Remove the three (x3) factory rubber grommets from the bottom of the factory airbox.



Figure C

Refer to Figure C for Steps 9-11

Step 9: Install the three factory grommets onto the bottom of the Takeda housing as shown.

Step 10: Install the Takeda housing into the vehicle (7).

Step 11: Install the top of the resonator tube that was removed in Step 7 and tighten the factory housing screw that was removed in Step 5.



Figure D

Refer to Figure D for Steps 12-13

Step 12: Remove the crankcase ventilation hose off of the valve cover (8).

Step 13: Remove the coolant hose and replace it with the supplied hose (9) using the factory clips.

(Caution: Make sure vehicle has cooled down before removing this hose. Coolant can be extremely hot and cause serious burns. Have a rag ready to catch any coolant that leaks out of this hose).



Figure E

Refer to Figure E for Steps 14-15

Step 14: Remove the MAF sensor off the factory intake tube.

Step 15: Install the MAF sensor onto the Takeda tube using the factory hardware ⑩ .



Figure F

Refer to Figure F for Steps 16-21

Step 16: Install the silicone coupling onto the throttle body with the clamps provided.

Step 17: Install the Takeda filter into the housing using the supplied clamp (11).

Step 18: Install the Takeda tube onto the silicone coupling and air filter.

Step 19: Re-connect the MAF plug onto the MAF sensor.

Step 20: Connect the new crank case hose onto the tube and valve cover (12).

Step 21: Tighten and verify that all clamps are secure. Your installation is now complete. Thank you for choosing Takeda USA!

Note: Place enclosed CARB EO sticker on or near the device on a smooth, clean surface. Eo identification label is required to pass the smog inspection.







advanced FLOW engineering, inc.
252 Granite Street Corona, CA 92879